

EVACUATION DIAGRAM

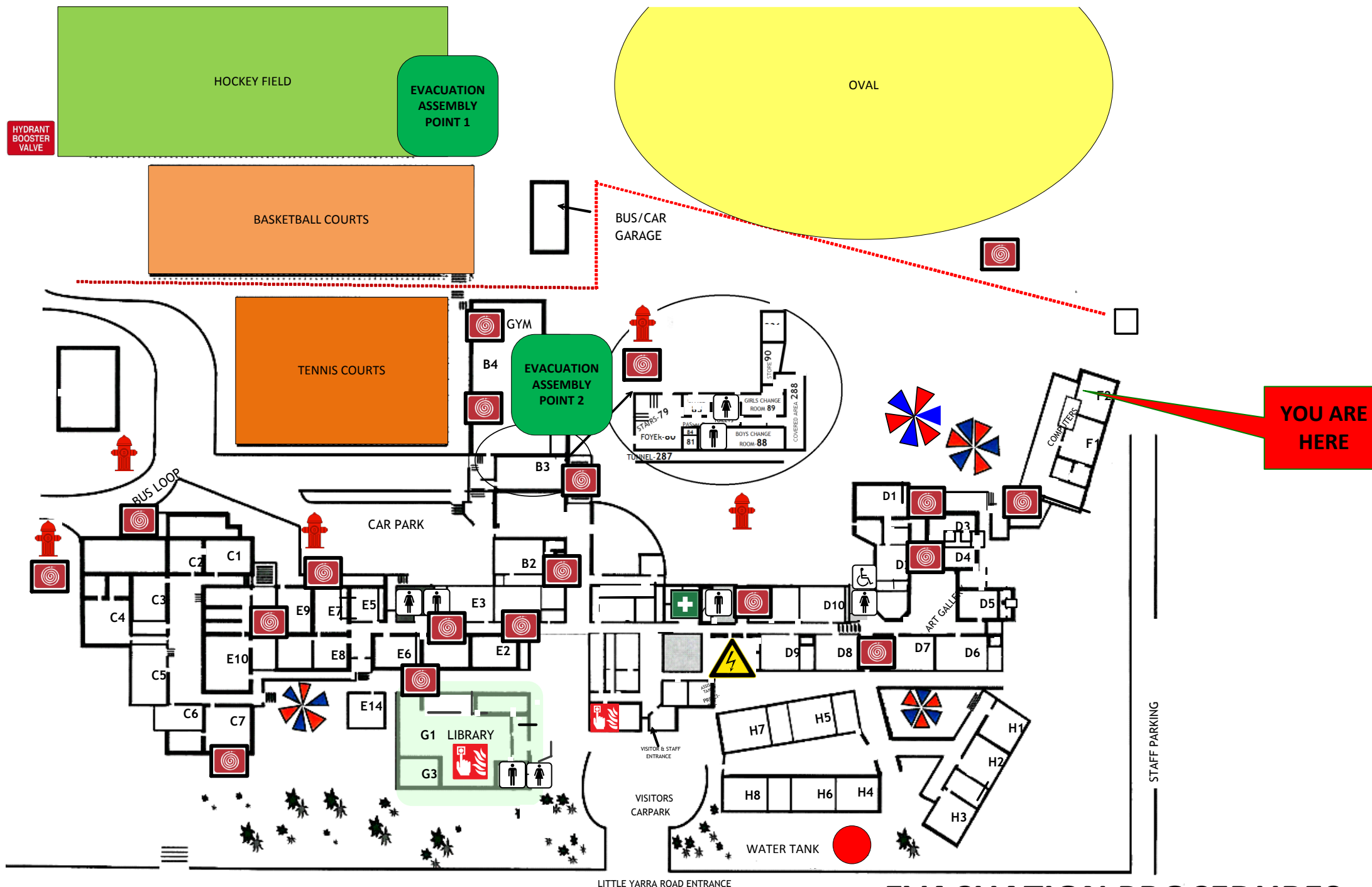

81 LITTLE YARRA ROAD
YARRA JUNCTION
VICTORIA 3797

03 5967 1877

DRAFTED 11/01/2016 EXPIRES 11/01/2019
MUST BE REVIEWED ANNUALLY



LEGEND

-  EXTINGUISHER
-  FIRE HOSE
-  FIRE HYDRANT
-  MAIN SWITCHBOARD
-  FIRST AID
-  ALARM PANEL
-  BOOSTER POINT

EVACUATION PROCEDURES

- Leave Immediately using the nearest Safe Exit, Look for signs of danger and take care while doing so, Listen to and follow all instructions given by officers and wardens
- Move quickly, Stay low below Smoke but Do NOT Run
- Move towards and reach your designated Evacuation Assembly Area
- Report any incident, accident, observation or injury to Wardens and Officers especially if you are aware of anybody still inside
- Remain in the Evacuation Assembly Area until told you may leave by Fire Wardens or Emergency Officers



HOW TO USE A FIRE EXTINGUISHER

- PULL THE PIN**
Break seal and test the extinguisher
- AIM AT THE BASE OF THE FIRE**
Make sure you have a means of escape
- SQUEEZE THE HANDLE**
To operate the extinguisher and discharge the agent
- SWEEP FROM SIDE TO SIDE**
Completely extinguish the fire

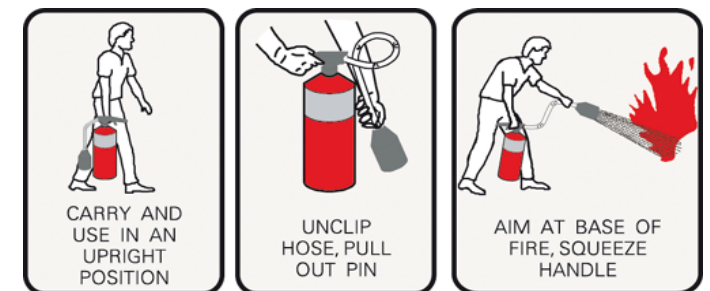

IN CASE OF FIRE

- R** REMOVE PEOPLE FROM IMMEDIATE DANGER
- A** ALERT NEARBY EMPLOYEES AND MEMBERS OF THE PUBLIC TO EVACUATE THEN DIAL **000**
OPERATE MANUAL CALL POINT IF APPLICABLE
- C** CONFINE SMOKE & FIRE, CLOSE DOORS & WINDOWS IF SAFE TO DO SO, STAY LOW UNDER SMOKE
- E** EXTINGUISH AND CONTROL FIRE IF SAFE TO DO SO



AUSTRALIA
FIRE PROTECTION
AFP GROUPS

1300 475 715

NOT TO SCALE*